

Courses Down
French Creek

S 22 1/2 E 20 P^{cs}
 S 12 E 32
 S 7 1/2 E 27
 S 21 1/2 E 38
 S 12 1/2 W 39
 S 33 1/2 W 10
 S 58 W 14
 N 76 W 29.3
 S 47 W 36
 S 14 1/2 W 10

 255.3 Perches

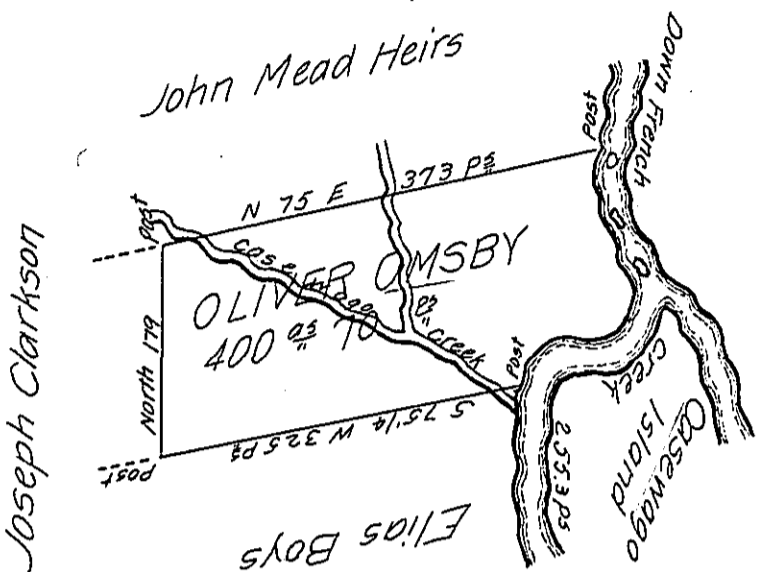

In Pursuance of a Warrant for 384^{ac} & 119 perches of Land dated 22nd day of February 1820 was surveyed the 6th day of July 1820 for Oliver Ormsby the above described tract of Land Containing 400^{ac} & 70^{ac} & allowance of six p^{cs} Cent for Roads & C. situate on and adjoining the west side of French Creek in Mead Township Crawford County Pa and that Elizabeth Rogers, was Residing on the same & there appeared to be upwards of 100^{ac} of Land under Cultivation

To Jacob Spangler Esquire S.G.

James Herrington D.Y.S.

IN TESTIMONY that the above is a copy of the original remaining on file in the Department of Internal Affairs of Pennsylvania, made conformably to an Act of Assembly approved the 16th day of February, 1833, I have hereunto set my Hand and caused the Seal of said Department to be affixed at Harrisburg, this ninth day of March 1906

Loose R. Rosson
 Secretary of Internal Affairs.